

135 LINWOOD AVENUE

RECORD DRAWINGS

DR.
WILLIAM
CAPICOTTO

135 LINWOOD AVE.
BUFFALO, N.Y.

design ■ renovations ■ interiors

CONWAY
&
COMPANY
ARCHITECTS

2320 WEHRLE DRIVE
WILLIAMSVILLE, NY
14221
PH. 631-1160 FAX 631-1128

No.

© 2017 CONWAY AND COMPANY ARCHITECTS
This drawing may not be reproduced, copied
altered or otherwise used without the
written consent of the Architect.

Drawings conveyed for acquisition of building
permit shall be signed, sealed and dated.

Revisions / Submissions Date

RECORD DRAWING

Issue Date 12-4-17

Sheet Title

FLOOR PLANS

Drawn by: JW

Checked by:

Scale: AS NOTED

Project No.:

Drawing No.

A1

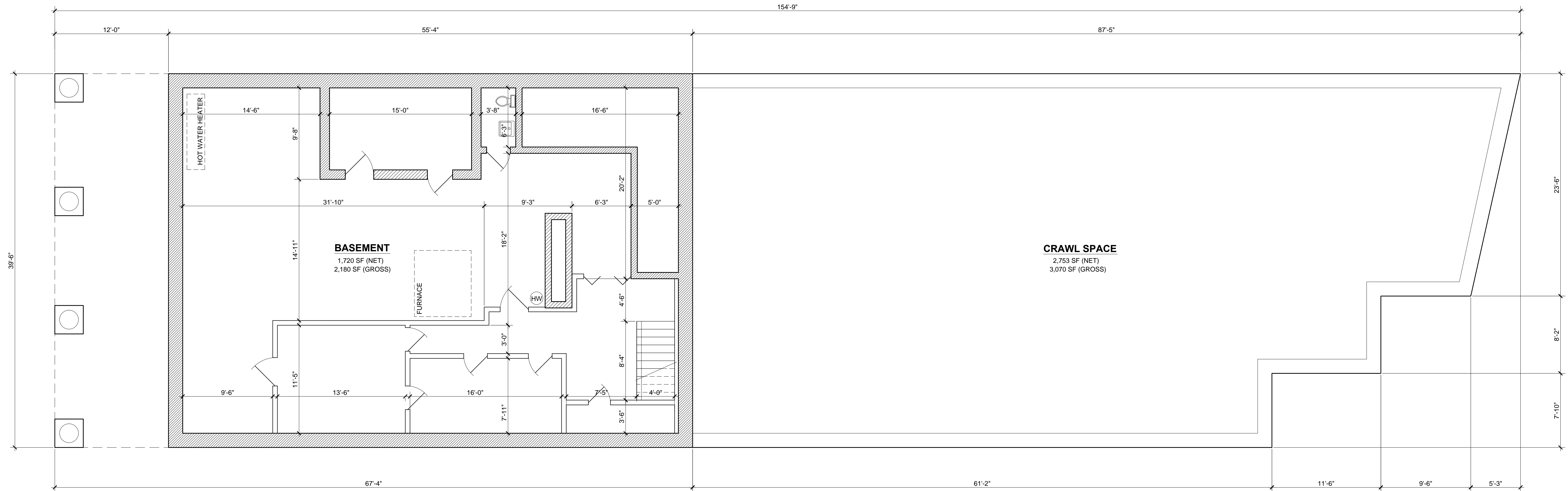

1 BASEMENT PLAN

3/16" = 1'-0"

135 LINWOOD AVENUE

BUILDING STATISTICS

BUILDING FLOOR FOOTPRINT	TOTAL FLOORS
5,250	2 - (BASEMENT)

TYPE	SF NET	TOTAL SF GROSS
BASEMENT	1,720	2,180
1ST FLOOR	4,865	5,250
2ND FLOOR	1,455	1,610
TOTAL	8,040	9,040